



COLD FLEXIBILITY  
**-20 °C**

# ELASTOFLEX S6 AF mineral

**ELASTOFLEX S6 AF MINERAL** is an elastomeric waterproofing membrane with outstanding performance indicated for surfaces subject to cyclical movement.

 <p><b>Guaranteed Quality</b> UNI EN ISO 9001:2008 and UNI EN ISO 14001:2004</p>	 <p><b>All year membranes</b></p>
 <p><b>Product in compliance</b> with European Standards</p>	 <p><b>Lateral and endlap</b> sealing strips</p>
 <p><b>Polyglass is a member of</b> Green Building Council</p>	 <p><b>Easily flamed non-stick</b> polyethylene film</p>
 <p><b>Bituminous membrane</b> polymeric matrix ageing control.</p>	 <p><b>Certificazione SITAC</b> B<sub>ROOF</sub> (t2)</p>

## PROFESSIONAL LINE

WATERPROOFING MATERIALS AND INSULATING SYSTEMS

# POLYGLASS®/Q



*Adds value!*



# ELASTOFLEX S6 AF mineral

## TECHNICAL DESCRIPTION

**ELASTOFLEX S6 AF MINERAL** is an elastomeric waterproofing membrane with outstanding performance, made of a latest generation distilled bitumen-based compound and thermoplastic elastomeric resin (SBS) with elevated elasticity reinforced with a continuous non-woven polyester fabric and longitudinal glass fibre. In addition to being rotproof, this reinforcement gives the membrane excellent mechanical characteristics in terms of elongation and tensile strength, resistance to puncture, and dimensional stability. The innovative technology used in these membranes offers a guarantee of superior quality.

## DESTINATION

PRODUCT	SINGLE LAYER		MULTI-LAYER				ROOT BARRIER	VAPOUR BARRIER	FOUNDATIONS		UNDER ROOFING TILES
	E.	U.H.P.	F.L.		U.L.				R.D.	P.	
			E.	U.H.P.	E.	U.H.P.					
4,5 kg Mineral			•								
5,5 kg Mineral	•		•								

F.L.: Finishing Layer - U.L.: Underlying Layer - R.D.: Rising Damp - P.: Pitch - E.: Exposed - U.H.P.: Under Heavy Protection

The exceptional characteristics of elasticity provided by SBS polymer suit **ELASTOFLEX S6 AF MINERAL** particularly suitable to the waterproofing of metal, prefabricated structures subject to cyclical movement or considerable dimensional variation. Elevated chemical-physical and mechanical properties guarantee perfect adhesion to the support surfaces and between layers.

**ELASTOFLEX S6 AF MINERAL** has been certified to external fire performance in compliance to B<sub>ROOF(t2)</sub> ENV 1187 Test 2 valid on every substrate with density  $\geq 15 \text{ kg/m}^3$  and all slopes.

## APPLICATION: INSTRUCTIONS AND RECOMMENDATIONS

**ELASTOFLEX S6 AF MINERAL** has its upperside protected by an even layer of colored or natural mineral slate chips and features (**BYSTOP** patented) lateral and endlap sealing strip for easy overlapping. Support surfaces must be dry, clean, and sufficiently smooth and level. Application is made by light flaming with propane gas. Laying is quick and easy.



POLYFLAM *EasyTorch*

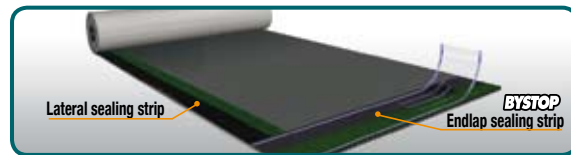

**BYSTOP** (endlap)

## STOCKING

Keep the products packed in the carton box in a dry place, away from direct sunlight. Do not place the pallets, one on top of another and the rolls must always be stocked in a vertical position. The contact with solvents and organic liquids may damage the product. Avoid application if the temperature is excessively low or high, avoid stamping (shoes with crampons, small objects or sharp edges). For further information contact Polyglass SpA Technical Office.

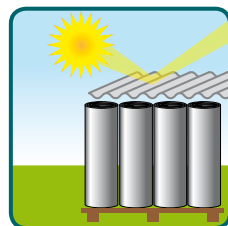

Keep out of direct sunlight.

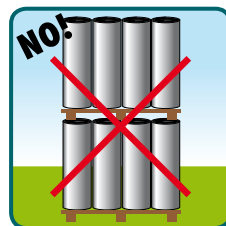

Avoid stocking pallets without evenly distributing the load.

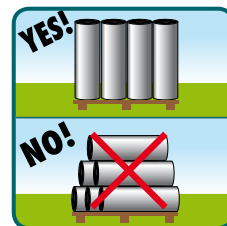

Keep the rolls standing.



Absolutely avoid puncturing the product.

## TECHNICAL SPECIFICATIONS

TEST METHOD	TECHNICAL CHARACTERISTICS	UNIT OF MEASURE	NOMINAL VALUES	NOMINAL VALUES
EN 1848-1	LENGTH	m	(8 -1%)	
EN 1848-1	WIDTH	m	(1 -1%)	
EN 1848-1	STRAIGHTNESS	mm/10 m	Exceeds	
EN 1849-1	THICKNESS	mm	NPD	
EN 1849-1	MASS PER UNIT AREA	kg/m <sup>2</sup>	5,5 (±10%)	
EN 1928-B	WATERTIGHTNESS	kPa	Exceeds	
EN 13897	WATERTIGHTNESS AFTER STRETCHING	%	Exceeds (10% a -10 °C)	
EN 13501-5	EXTERNAL FIRE PERFORMANCE	-	Broof (t2)	
EN 13501-1	REACTION TO FIRE	Euroclass	F	
EN 12316	PEEL RESISTANCE	N/50 mm	≥100	
EN 12317	SHEAR RESISTANCE	N/50 mm	≥600	
EN 12311-1	TENSILE PROPERTIES			
	MAXIMUM LOAD AT BREAK			
	Longitudinal	N/50 mm	≥800	
	Transversal	N/50 mm	≥800	
	ELONGATION AT BREAK			
	Longitudinal	%	≥35	
	Transversal	%	≥35	
EN 12691-A	RESISTANCE TO IMPACT AT 23 °C	mm	≥1000	
EN 12691-A	RESISTANCE TO IMPACT AT 10 °C	mm	≥200	
EN 12730-A	RESISTANCE TO STATIC LOADING AT 23 °C	kg	≥20	
EN 12310-1	RESISTANCE TO TEARING			
	Longitudinal	N	≥150	
	Transversal	N	≥150	
EN 13948	RESISTANCE TO ROOTS PENETRATION	-	-	
EN 1107-1	DIMENSIONAL STABILITY	%	≤0,3	
EN 1109	COLD FLEXIBILITY	°C	≤-20	
EN 1110	FLOW RESISTANCE AT ELEVATED TEMPERATURE	°C	≥100	
EN 1109	COLD FLEXIBILITY AFTER HEAT AGEING	°C	≤-10	
EN 1110	ARTIFICIAL AGEING BEHAVIOUR (FLOW RESISTANCE)	°C	-	
EN 1296	ADHESION OF GRANULES	%	≤30	

ELASTOFLEX S6 AF MINERAL

Thickness and weight parameters are indicative only for Italian market. In compliance with EN 13707 product standards (layers for roofing).

## DIMENSIONS - PACKAGING

PRODUCT	THICKNESS mm	WEIGHT kg/m <sup>2</sup>	DIMENSIONS m
ELASTOFLEX S6 AF MINERAL Grey	-	4,5	1x10
ELASTOFLEX S6 AF MINERAL Other colours	-	4,5	1x10
ELASTOFLEX S6 AF MINERAL Grey	-	5,5	1x8
ELASTOFLEX S6 AF MINERAL Other colours	-	5,5	1x8

## AVAILABLE COLOURS

Upperside protected with colored mineral slate chips:



Grey



Green



Red



White



Brown

Considering the various situations of use, the numerous types of support surfaces and the possibilities for use, inside de COMPLEX WATERPROOF LAYERING, Polyglass SpA cannot assume any liability for damages derived from the products results in terms of function or aesthetics.



FLAT WALKABLE ROOF



FLAT NON-WALKABLE ROOF



FLAT ROOF WITH FRETTED METAL PLATE



INDUSTRIAL SHIELD ROOFING



ARCHED ROOFING



PITCHED ROOFING



FOUNDATIONS



UNDERGROUND PARKING



ROOFTOP PARKING



ROOF GARDENS



BRIDGES AND AQUEDUCTS



RESERVOIRS AND CANALS



GALLERIES AND TUNNELS



RECONSTRUCTION OF WATERPROOFING MEMBRANE  
RECONSTRUCTION WITH THERMAL INSULATION  
SPECIAL RECONSTRUCTION



SPECIAL PARTS AND DETAILS



SPECIAL ROOFING

# WATERPROOFING MEMBRANES

## APPLICATION METHOD

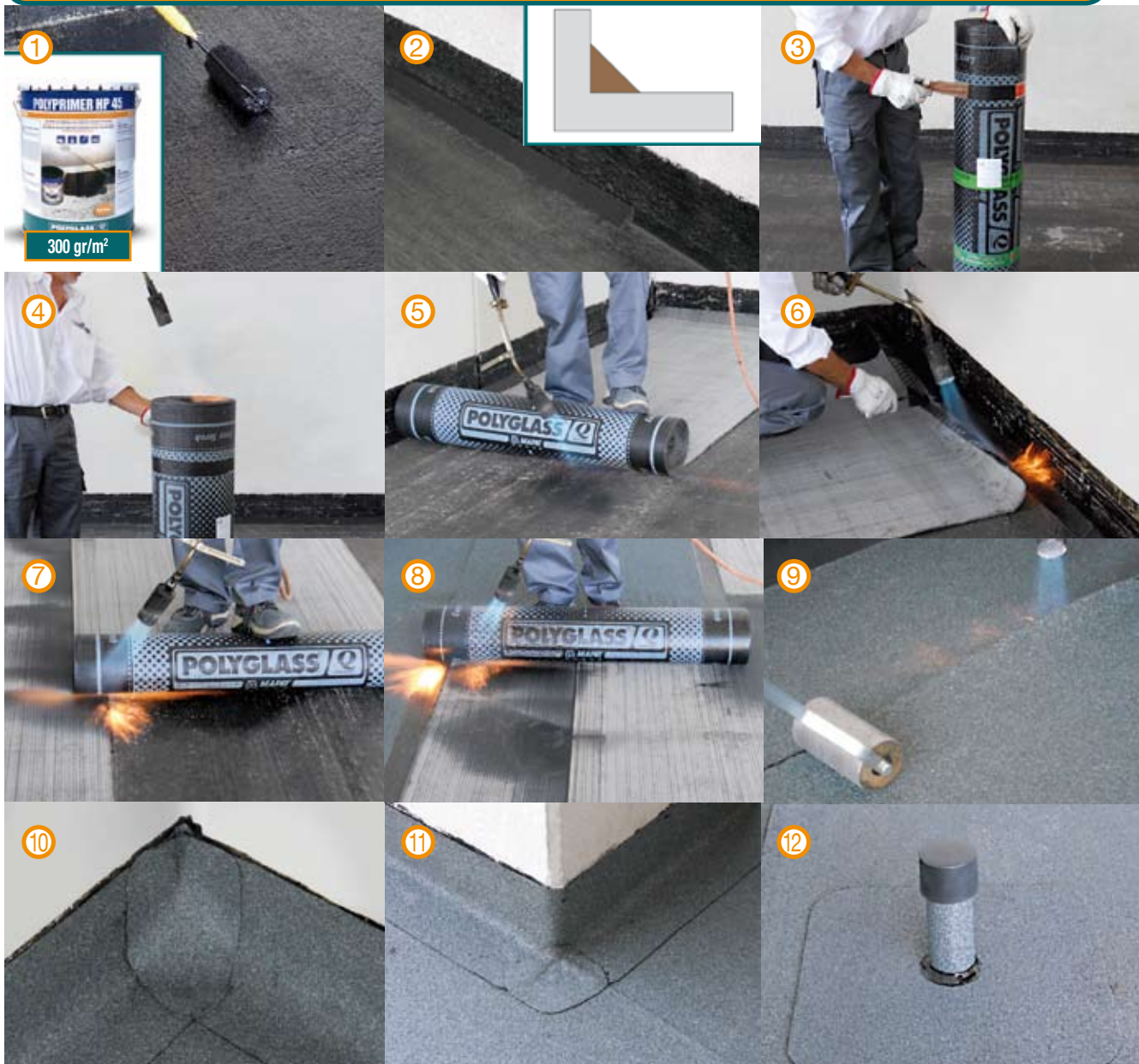

- ① Treat the area to be waterproofed with bituminous primer (POLYPRIMER HP 45 Professional).
- ② Position the "Bordangolo" near the horizontal-vertical joint.
- ③ Completely strip away the product identification tape.
- ④ In the colder months, we recommend heating up the roll of membrane before applying it.
- ⑤ Position and apply the sheet by flaming its bottom surface.
- ⑥ Pull the sheet up to a certain height against vertical surfaces.
- ⑦ Apply the second sheet with adequate overlapping.
- ⑧ Lay the second layer by overlapping. Do not cross the sheets.
- ⑨ Roll the overlapping areas using the special pressing roller.
- ⑩ Example of internal corner.
- ⑪ Example of external corner.
- ⑫ Example of vent pipe.

POLYGLASS SPA reserves the right to make any and all modifications required for the ongoing perfection of the product without notice.

WATERPROOFING MATERIALS AND INSULATING SYSTEMS

**POLYGLASS® Q**

MAPEI  
GROUP

*Adds value!*

**POLYGLASS SPA**

Registered Office: Viale Jenner, 4 - 20159 MILANO

Head Office: Via dell'Artigianato, 34 - 31047 Ponte di Piave (TV) - Italy

Tel. +39 04227547 - Fax +39 0422854118 - [www.polyglass.com](http://www.polyglass.com) - [info@polyglass.it](mailto:info@polyglass.it)