

Drawing B-1005

Rooftop parking with road binder finish

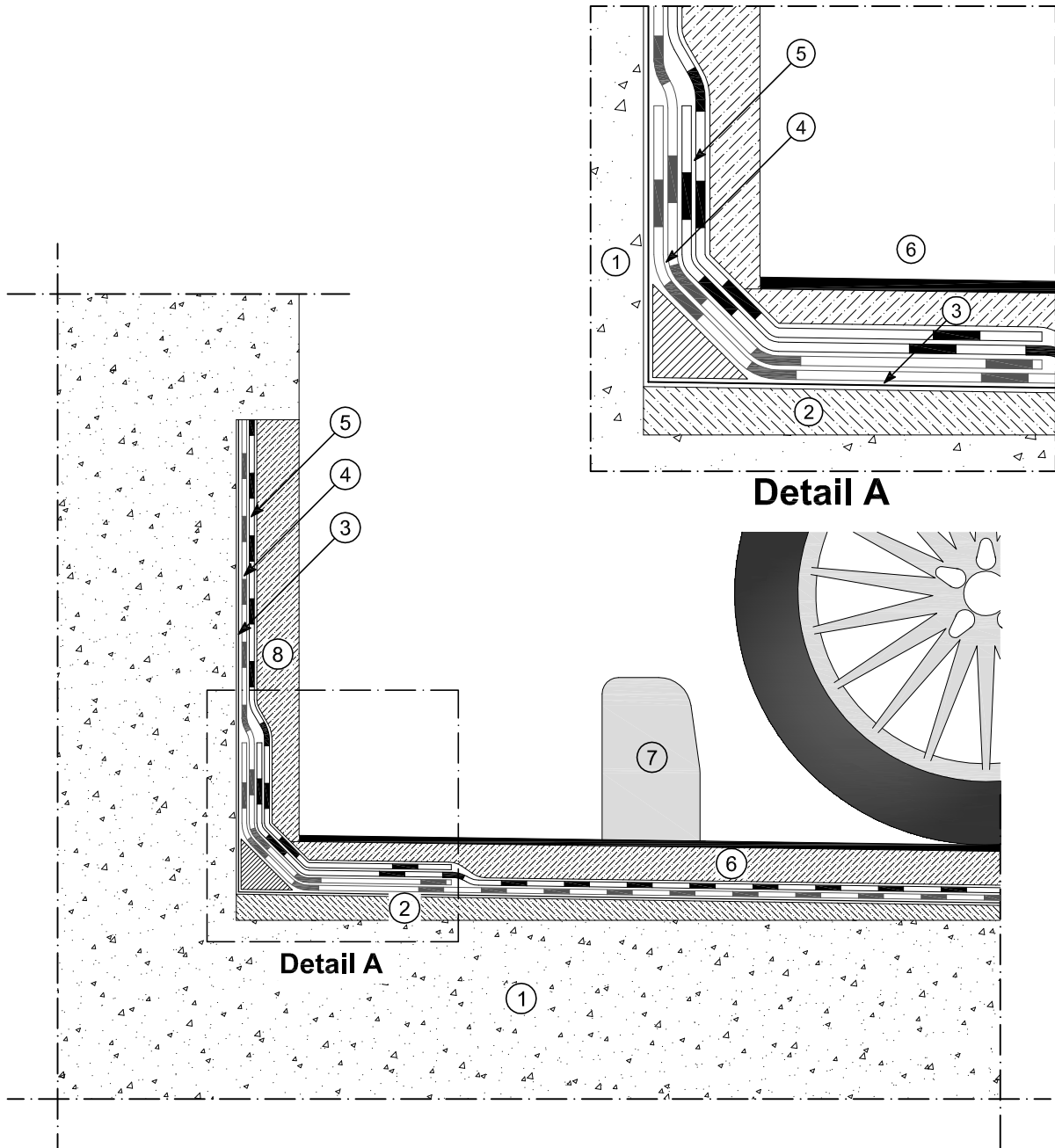

- | | |
|--|--|
| ① Structure | ⑤ Bituminous membrane (2nd layer) |
| ② Concrete gradient sceed | ⑥ Road binder finish (binder laying temperature: 140/150°C) |
| ③ Bituminous primer POLYPRIMER HP 45 PRO | ⑦ Bollard protection of vertical tun-up
(ex. concrete bollard, guard rail, curb/sidewald) |
| ④ Bituminous membrane (1st layer) | ⑧ Vertical turn-up protected with screen and plaster |

05.03.2012

reproduction prohibited
without cite the source